

McKenzie, Victoria

From: jadu-www@scec25.servers.jadu.net on behalf of noreply@lichfielddc.gov.uk
Sent: 07 August 2020 09:50
To: Generic - Licensing
Subject: Pavement seating licence application - 94395

Name: Susan Pettitt

Phone:

Phone (alternative): 01543 263501

Email:

Address:

Name of premises: Boomers

Premises address: 9 Breadmarket Street, Lichfield, WS13 6LG

Purpose of application: Use of the furniture by the licence holder to sell or serve food or drink supplied from, or in connection with relevant use* of, the premises.

Days required: Every day, Monday to Sunday inclusive

Times required: 09:00-17:00

Duration of licence: Maximum, until 30 September 2021

Type of furniture: Tables, counters or shelves on which food or drink can be placed, Chairs

Other seating?

Other items?

I understand and agree to the above declarations.

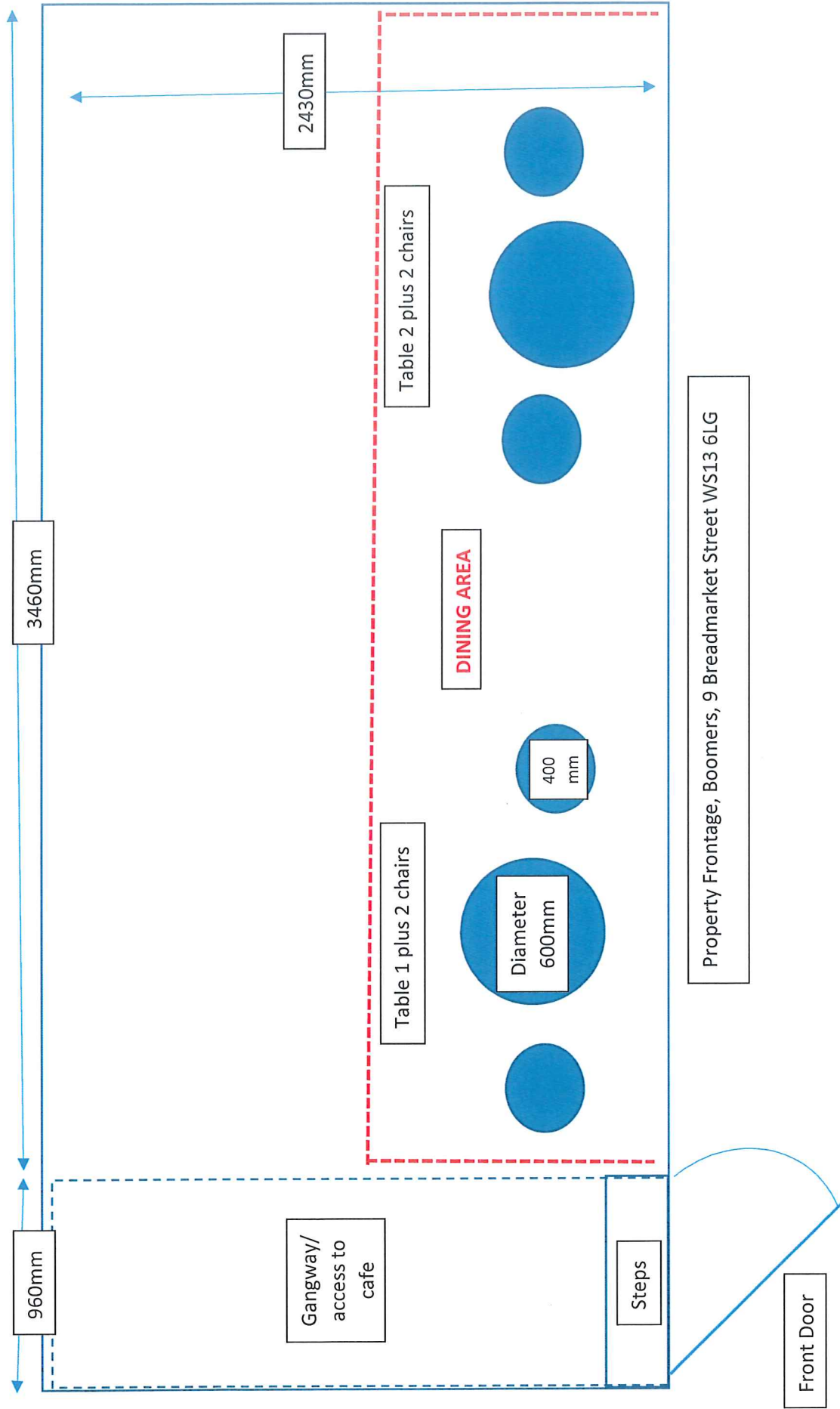

3460mm

960mm

2430mm

Table 2 plus 2 chairs

Table 1 plus 2 chairs

DINING AREA

Diameter 600mm

400 mm

Steps

Property Frontage, Boomers, 9 Breadmarket Street WS13 6LG

Front Door

Gangway/
access to
cafe

Proposed 4 x Chairs and 2 x Tables for Pavement Outside of Boomers, 9 Breadmarket Street, WS13 6LG



Dimensions:

- Table diameter 600mm
- Chair diameter 400mm