

McKenzie, Victoria

From: jadu-www@scec25.servers.jadu.net on behalf of noreply@lichfielddc.gov.uk
Sent: 18 September 2020 09:16
To: Generic - Licensing
Subject: Pavement seating licence application - 99945

Name: Marston's PLC Marstons PLC

Phone: 01142668664

Phone (alternative):

Email: probson@john-gaunt.co.uk

Address: Marstons House, Brewery Road, Wolverhampton, WV1 4JT

Name of premises: Kings Head

Premises address: Kings Head 21, Bird Street, Lichfield, WS13 6PW

Purpose of application: Use of the furniture by other persons for the purpose of consuming food or drink supplied from, or in connection with relevant use* of, the premises.

Days required: Monday to Sunday

Times required: 10.00 - 00.00 Sunday to Wednesday, 10.00 - 01.00 Thursday to Saturday

Duration of licence: 30 September 2021

Type of furniture: Tables, counters or shelves on which food or drink can be placed, Chairs, Umbrellas, Barriers

Other seating?

Other items?

I understand and agree to the above declarations.

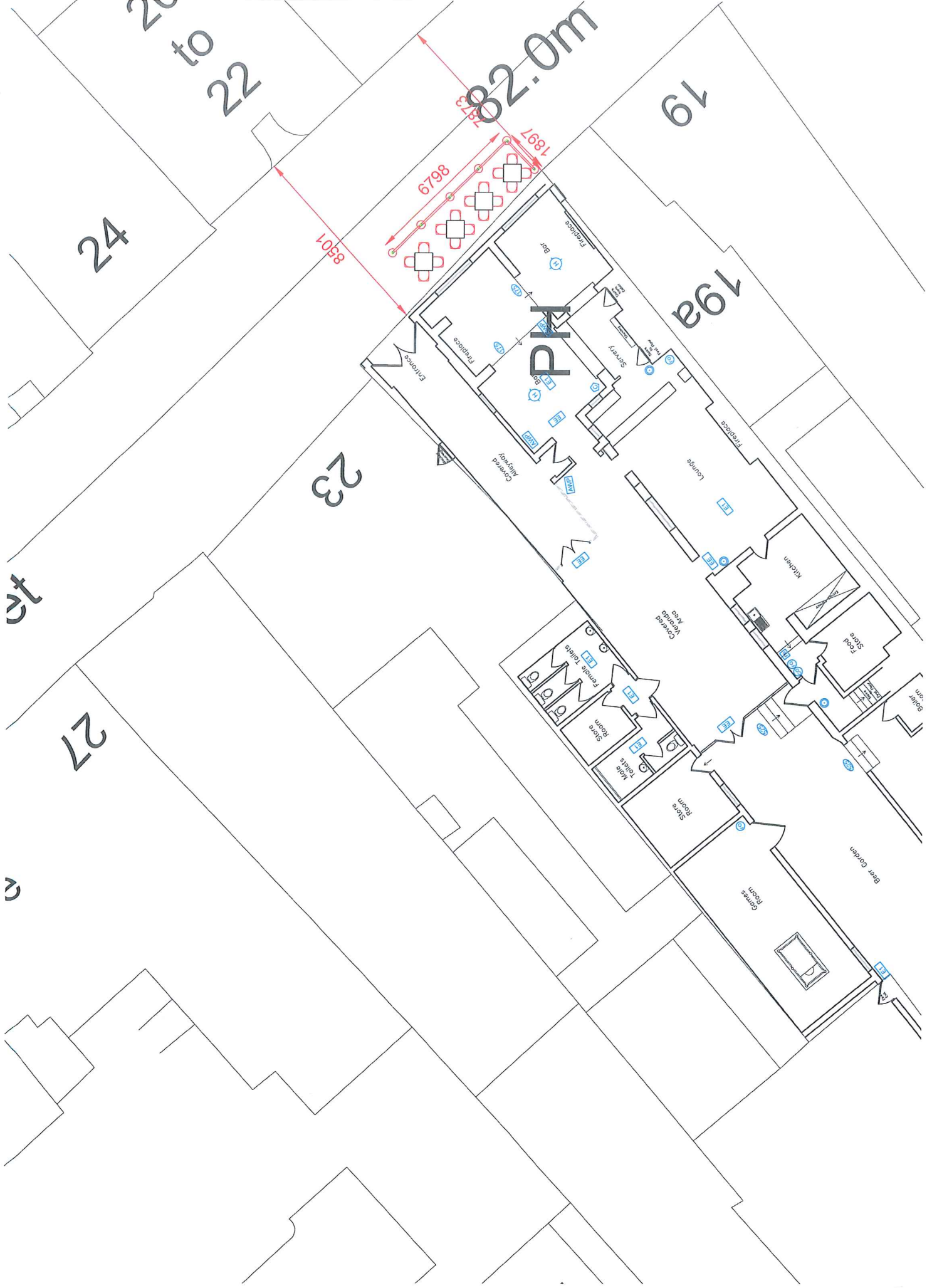

24

20 to 22

82.0m

19

19a

PH

23

20

27

28

8501

7897.3

8671.9

1897

Beer Garden

Games Room

Store Room

Male Toilets

Female Toilets

Store Room

Food Store

Kitchen

Lounge

MW

Entrance

Exit

Exit

Exit

Exit

Exit

Boiler Room

